

Lawson State
COMMUNITY COLLEGE
Birmingham, Alabama

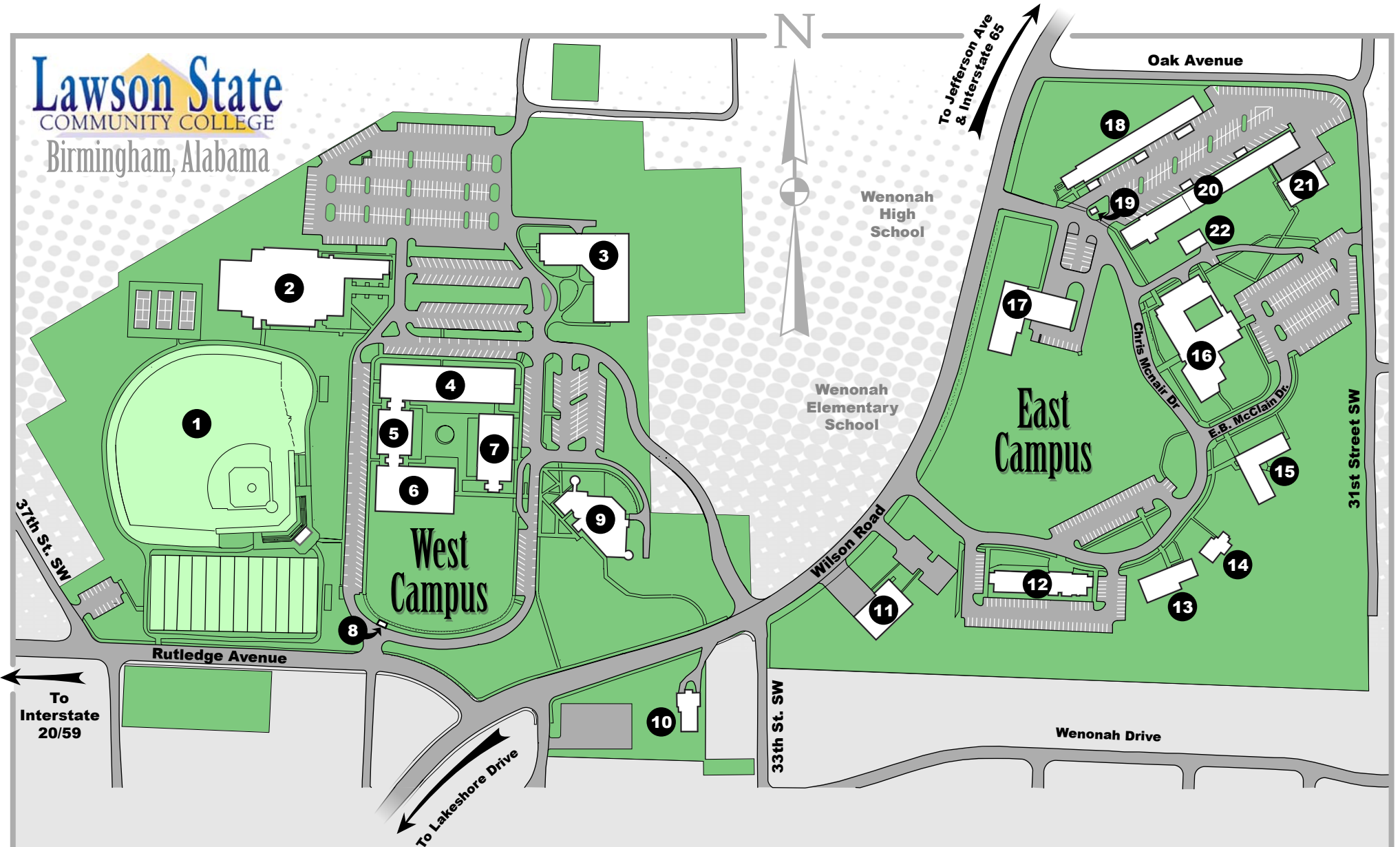

West Campus

- | | |
|---|--|
| 1 Roy W. Johnson, Jr. Baseball Field | 6 Library Building D |
| 2 Arthur Shores Fine Arts Building E | 7 Administration Building A |
| 3 Alabama Center for Advanced Technology & Training | 8 Information/Campus Security Building O |
| 4 Academic Building B | 9 Leon Kennedy Student Center Building F |
| 5 Science Building C | 10 Learning & Living Center |

East Campus

- | | |
|--|---|
| 11 City of Birmingham Fire Station No. 25 | 17 W. Fred Horn High Tech Building |
| 12 Residence Hall | 18 Shop Building I |
| 13 One Stop Career Center | 19 Information/Campus Security Building |
| 14 Small Business Center | 20 Facilities Building |
| 15 Ethel H. Hall Health Professions Building L | 21 Howard Building H |
| 16 A.G. Gaston Building G | 22 Boiler Building |